

Introduction to Photoshop

Adobe Photoshop is an advanced photo editing and graphics program that allows you to edit images and create your own artwork. In this Chapter you will be introduced to Photoshop's screen and some of its basic features, such as Layers. Layers are the building blocks of using Photoshop and you need to develop an understanding of how to use them in order to use Photoshop effectively.

Loading Photoshop

- 1 Load Photoshop and you will receive the Photoshop WELCOME screen, which allows you to start new documents or open files.

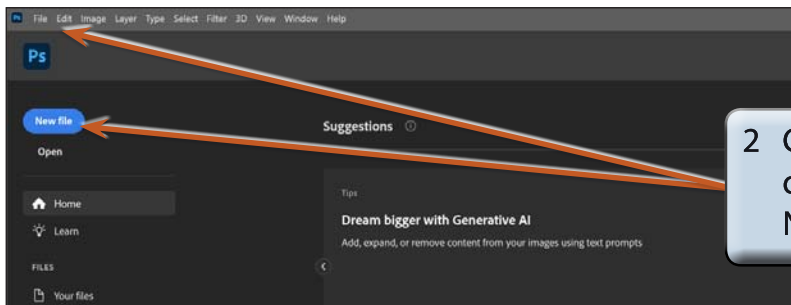

- 2 Click on the NEW FILE button (or display the FILE menu and select NEW).

- 3 You will be asked to select or enter the required settings for the page.

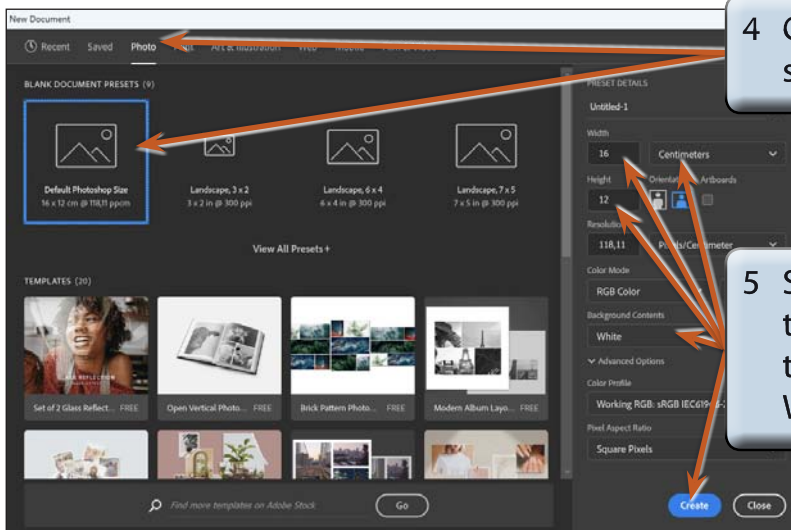

- 4 Click on PHOTO category and select the first (default) PRESET.

- 5 Set the WIDTH to 16 centimetres, the HEIGHT to 12 centimetres, the BACKGROUND CONTENTS to WHITE and select CREATE.

- 6 A blank page should be provided. The diagram at the top of the next page labels its sections.

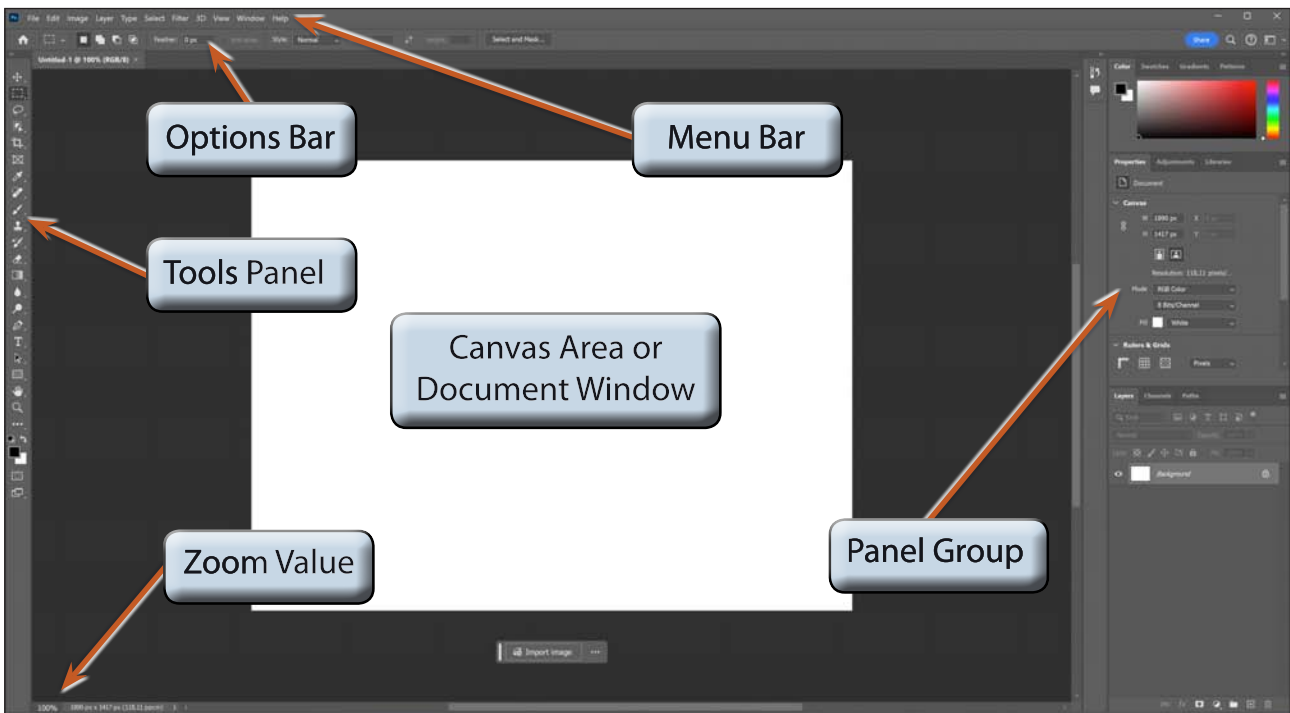

The Tools Panel

The TOOLS panel at the left of the screen provides general drawing and photo adjustment tools. The tools can be displayed in a single column or in two columns.

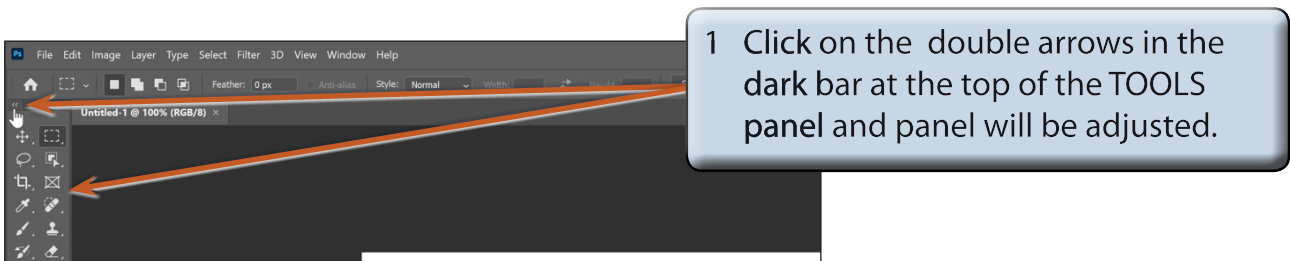

- 2 In these tutorials the TOOLS panel will be set to 2 columns, so click on the double arrows in the dark bar until the tools are displayed in 2 columns.

3 Tools that have a small arrow next to them have more tools within them.

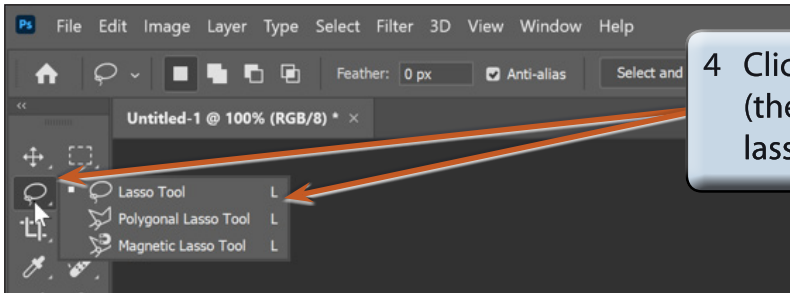

4 Click and hold on the LASSO tool (the second left tool) and the three lasso tool types will be displayed.

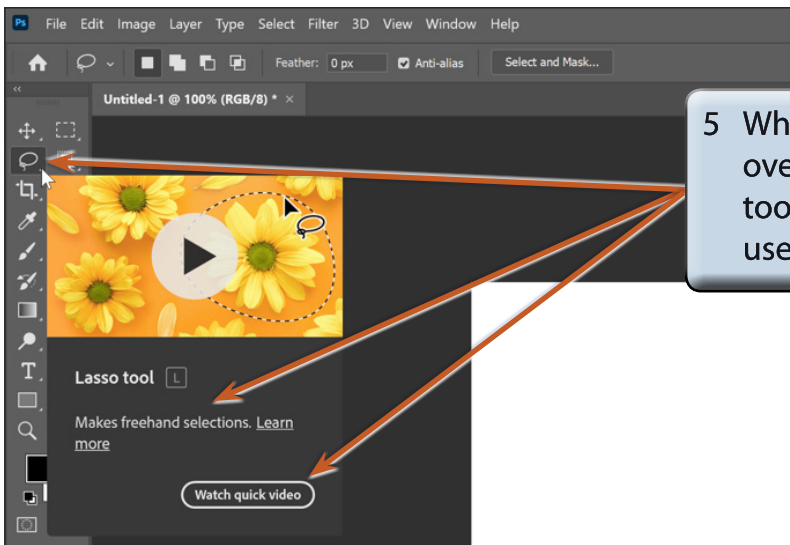

5 When you move the mouse pointer over a tool information about the tool and a sample video on how to use the tool are displayed.

6 Click and hold on some of the other tools to see what extra tools they contain.

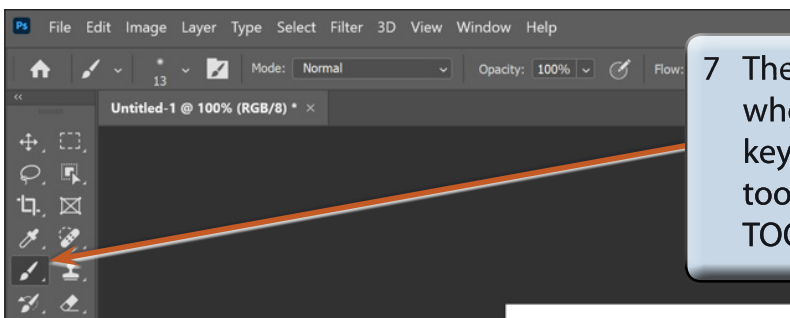

7 The letter displayed next to a tool when you click and hold on it is the keyboard shortcut to select that tool. Press the B key and the BRUSH TOOL should be selected.

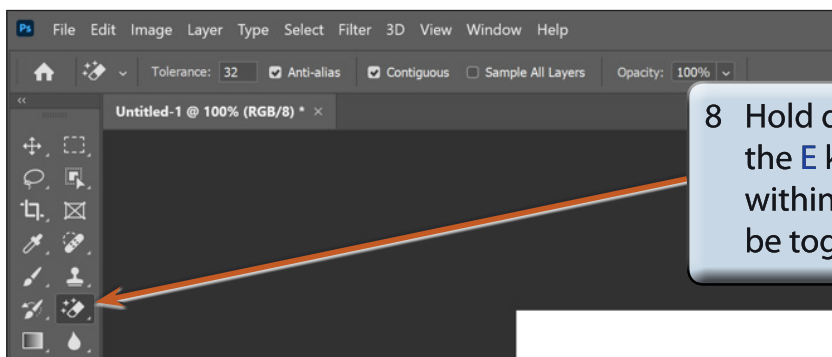

8 Hold down the **SHIFT** key and press the **E** key a few times. The tools within the ERASER TOOL group will be toggled.

Using the Tools

We will have a quick look at some of Photoshop's basic drawing tools. You may need to click and hold on a tool to select it depending on who has used to program before you.

- 1 Display the VIEW menu and select FIT ON SCREEN to zoom the canvas so that it fills the available screen area.

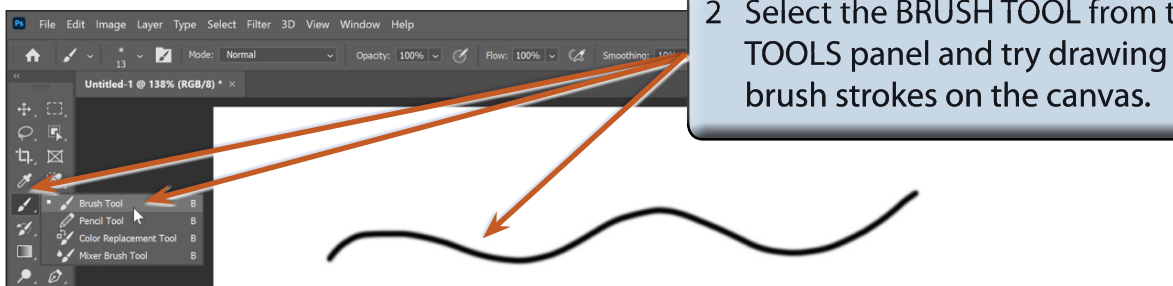

2 Select the BRUSH TOOL from the TOOLS panel and try drawing some brush strokes on the canvas.

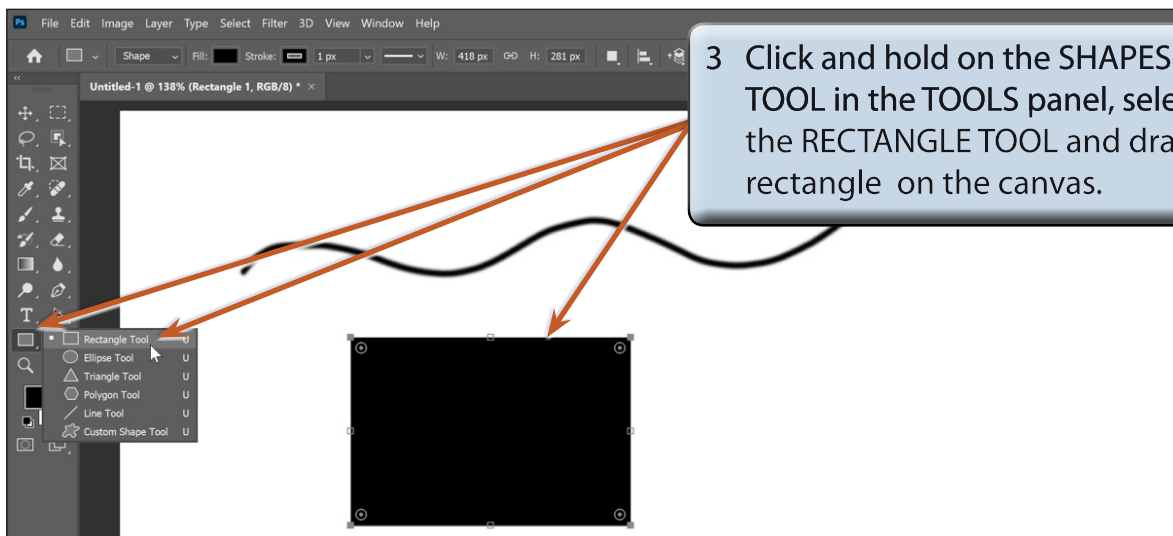

3 Click and hold on the SHAPES TOOL in the TOOLS panel, select the RECTANGLE TOOL and drag a rectangle on the canvas.