

Shape Edits, Fills and Effects

Adobe Illustrator provides a wide range of ways to fill objects and apply effects to them to make the objects look more realistic. In this chapter you will learn how to fill objects with colours and gradients, and how to apply effects to those objects.

Starting a New Document

- 1 Load Adobe Illustrator or close the current documents.
- 2 Select NEW FILE from the WELCOME screen or NEW from the FILE menu to start a new document.

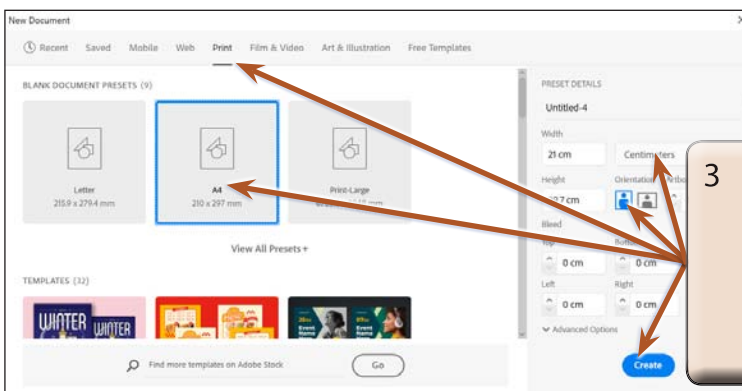

- 3 Select the PRINT profile followed by the A4 preset (or the paper size your printer uses), set the UNITS to CENTIMETRES, the ORIENTATION to PORTRAIT and select CREATE.

Editing Shapes

When shapes such as rectangles are drawn, a series of anchor points or handles are provided to allow the shapes to be edited. Once the shape is deselected, the SELECTION TOOL or DIRECT SELECTION TOOL can be used to edit it.

A Anchor Points

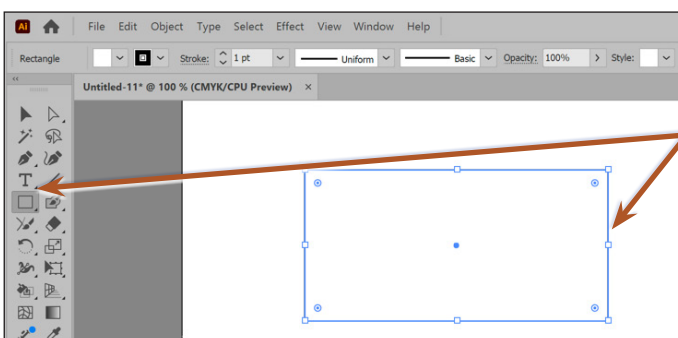

- 1 Select the RECTANGLE TOOL and draw a rectangle near the top centre of the Artboard. The default settings for the rectangle are a WHITE fill and a thin BLACK stroke (border). The D key can be pressed to return a rectangle to those settings.

- 2 A set of anchor points (or handles) are provided around the shape which allow for 'live editing'. The inner anchor points control the corners, the outer anchor points control the sides and the centre anchor point allows the shape to be moved.

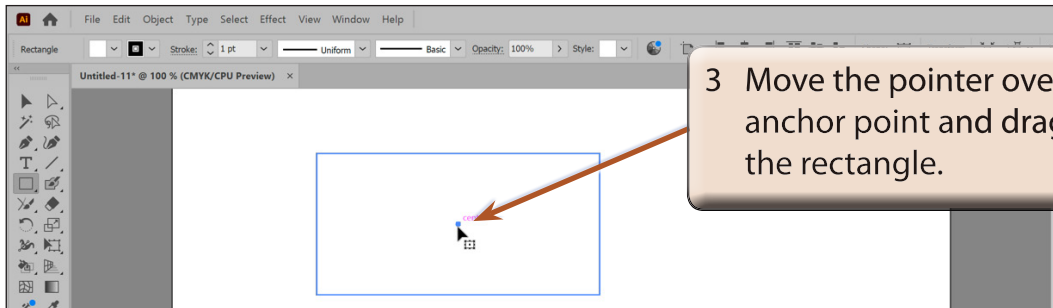

3 Move the pointer over the centre anchor point and drag it to move the rectangle.

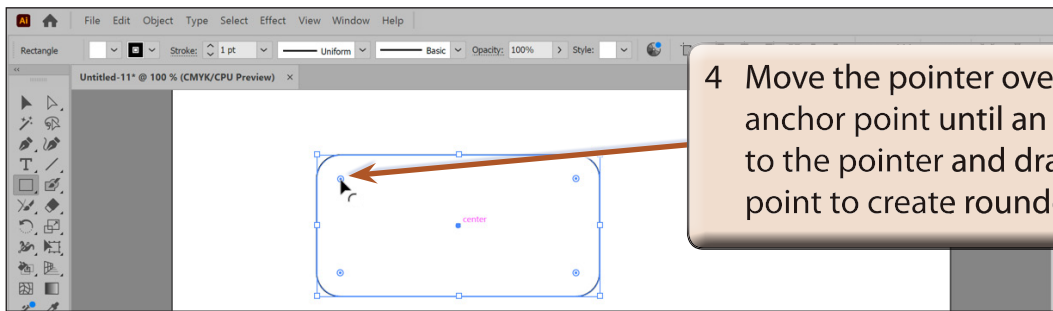

4 Move the pointer over an inner anchor point until an arc is added to the pointer and drag the anchor point to create rounded corners.

- 5 Just individual corners can be adjusted.

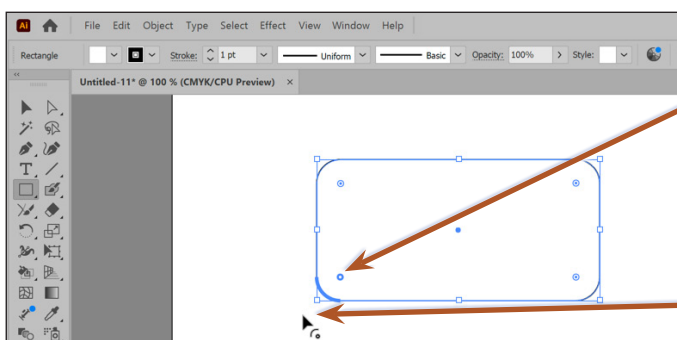

6 Move the pointer over the bottom left inner anchor point, click the mouse button to select it, an 'o' is added to the pointer and just that corner should be highlighted.

7 Drag the anchor point down and to the left to straighten just that corner.

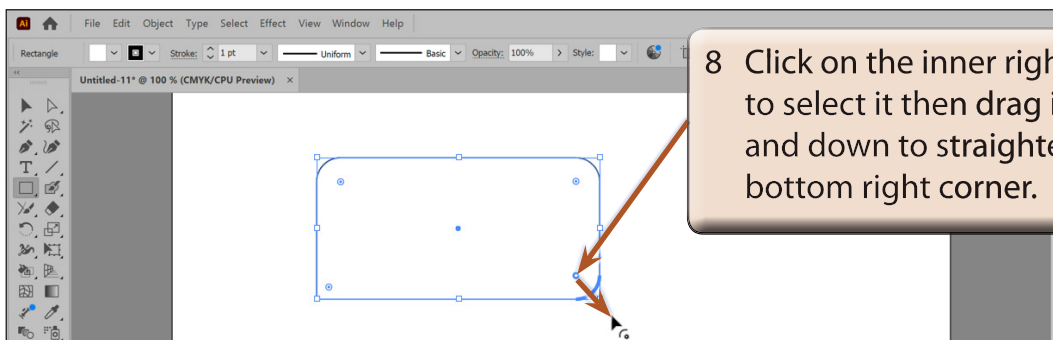

8 Click on the inner right anchor point to select it then drag it to the right and down to straighten just the bottom right corner.

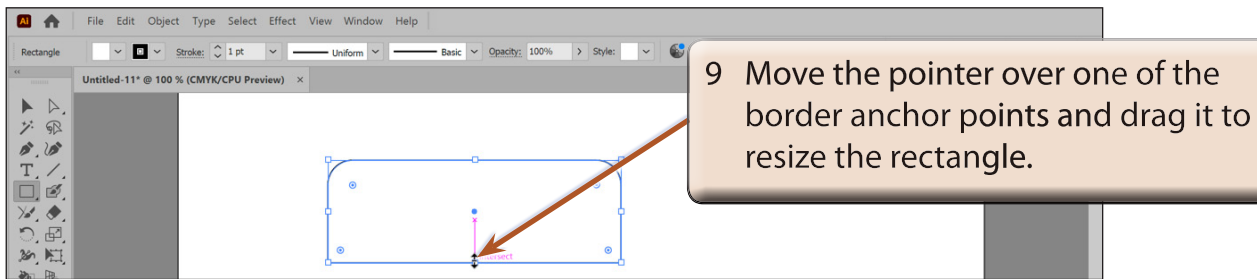

B The Selection Tools

Once a shape has been set, the SELECTION TOOL can be used to adjust the whole shape or the DIRECT SELECTION TOOL can be used to adjust individual anchor points.

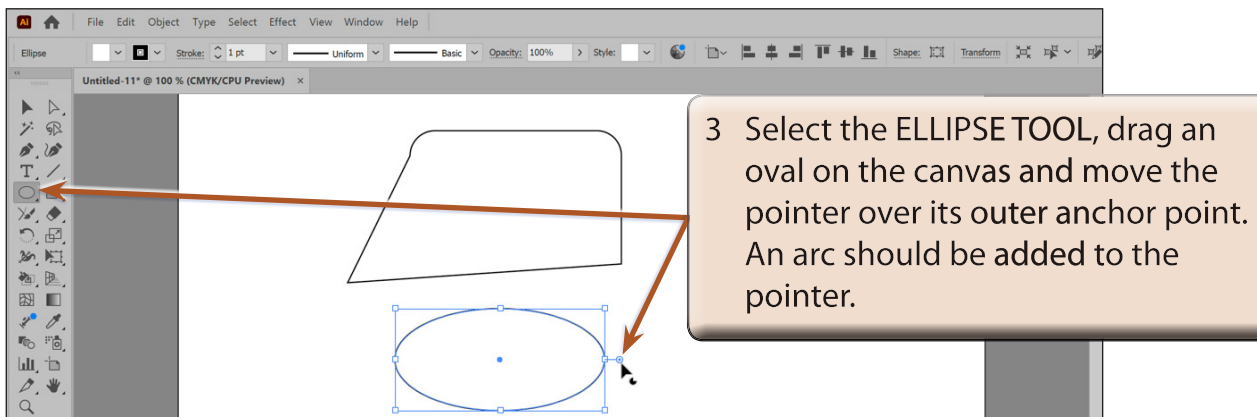
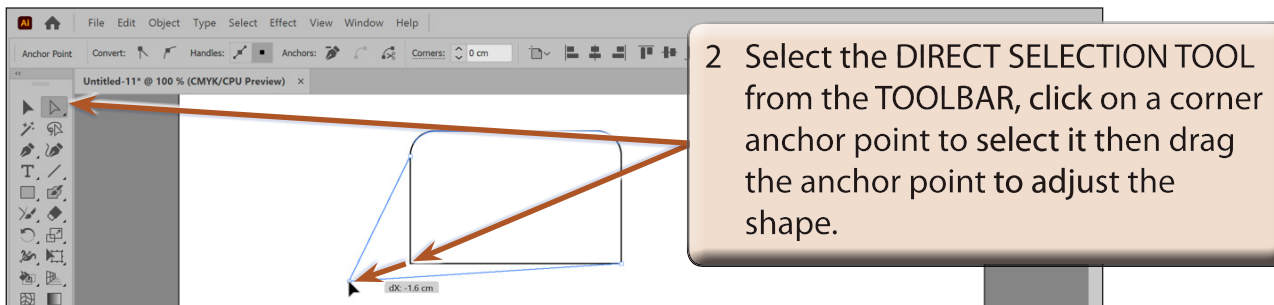
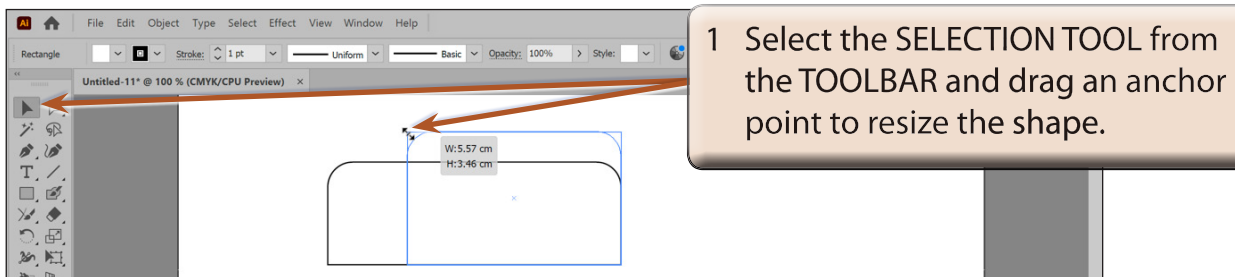

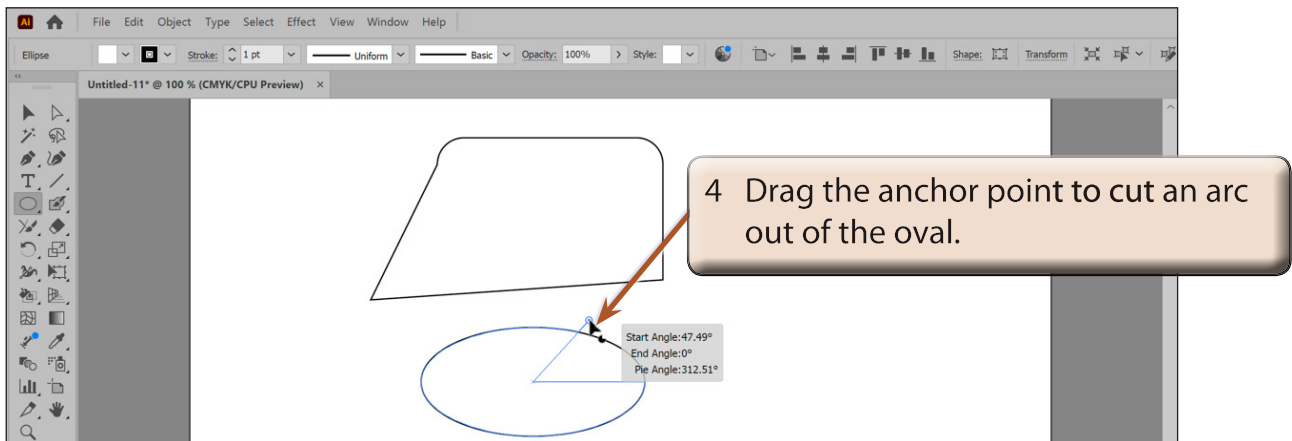

- 5 Try using the SELECTION and DIRECT SELECTION tools to further edit the oval.
- 6 Experiment with editing other shapes.

Filling Objects

Objects can be filled using the CONTROL and PROPERTIES panels, and the tools at the base of the TOOLBAR.

- 1 Press **CTRL+A** or **COMMAND+A** to select all the objects and delete them.

