

# Creating Forms

Forms allow information to be obtained from users of a web site. The ability for someone to purchase items over the internet or receive information from internet users has become a standard feature in many web sites. One way to do this is through the use of a FORM. Creating an interactive form is a two-part process. First you layout the form's objects (called fields) and then you link the objects to a Common Gateway Interface (CGI) script, which has to be done in consultation with an Internet Service Provider.

In this chapter you will create a form for the TravelWise Travel Agency.

## Starting the Page

The form will use the template that was created in the last chapter.

- 1 Load DreamWeaver or close the current pages and select CREATE NEW in the START screen, or select NEW from the FILE menu.

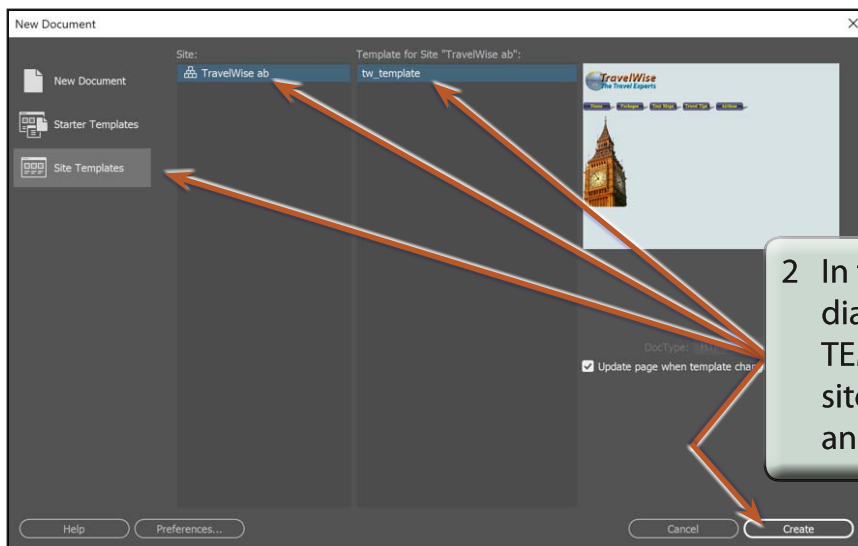

- 3 Check that the FILES panel is set to your TRAVELWISE site and the screen is set to DESIGN VIEW.

- 4 Save the page as:

orders.html

## Inserting the Form Tag

When creating a form you must tell the program that a form will be used to gather information from the user. All the details within a form MUST be contained within an area called a FORM TAG, so whenever you start a form it is best to insert a FORM TAG.

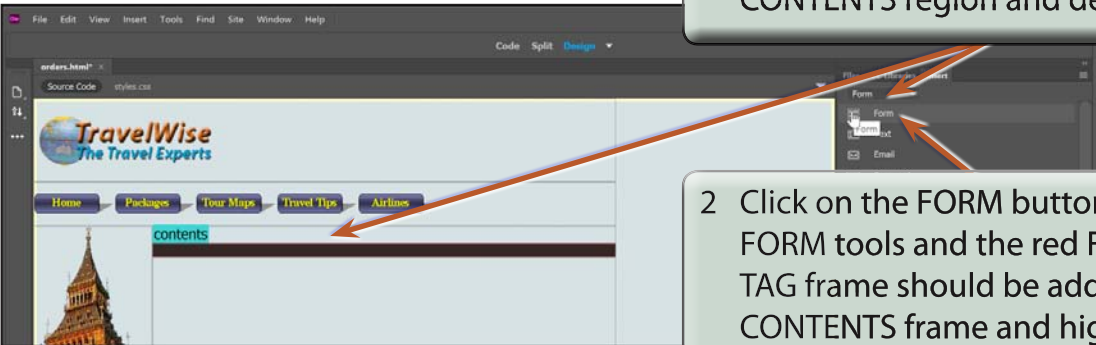

The screenshot shows the Adobe DreamWeaver interface with a website template titled "TravelWise The Travel Experts". The "contents" frame is highlighted in blue. The "INSERT" panel is open, and the "FORM" button is selected. A red dotted frame is visible around the "contents" frame, indicating the insertion of a form tag.

- 1 Open the INSERT panel, set its top box to the FORM tools then highlight the CONTENTS text in the CONTENTS region and delete it.
- 2 Click on the FORM button in the FORM tools and the red FORM TAG frame should be added to the CONTENTS frame and highlighted.

## Entering the Form Introduction

Text needs to be provided to explain details about the form to users.

### A Adding the Sub-Heading



The screenshot shows the Adobe DreamWeaver interface with the "contents" frame highlighted. The text "Ordering Travel Packages" is entered into the form. A red dotted frame is visible around the "contents" frame, indicating the insertion of a form tag.

- 1 Click in the content frame to remove the highlight, enter the heading:  
Ordering Travel Packages  
and press <enter> or <return> three times.

**NOTE:** As you create the form a red dotted frame will appear. This is the FORM tag and everything in the form should be within it.

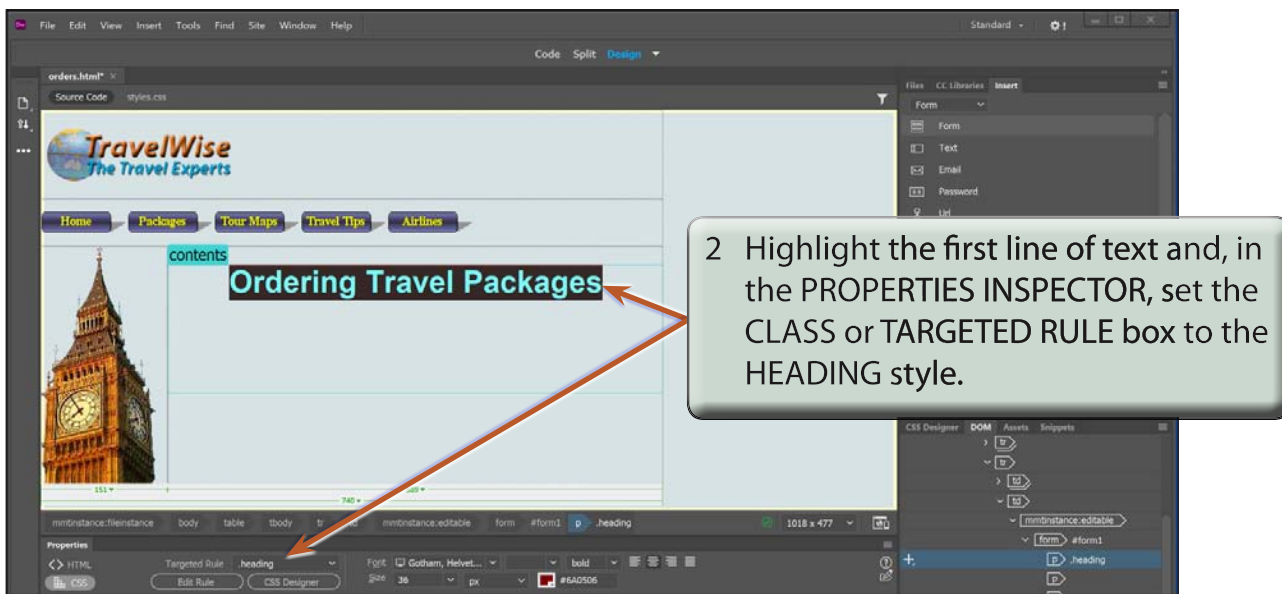

## B Entering a Message

A message about the order form will be added under the heading in a table.

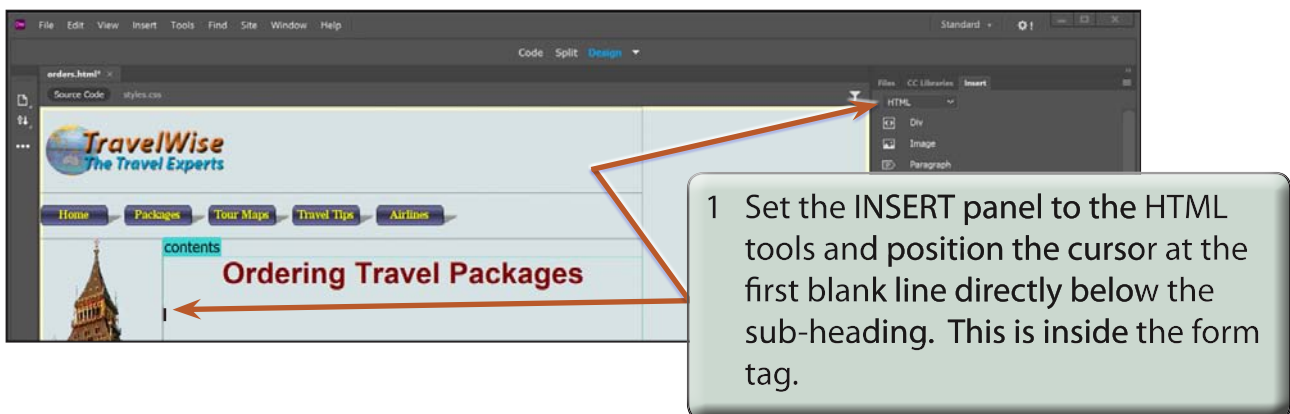

2 Click on the TABLE button in the HTML tools of the INSERT panel.

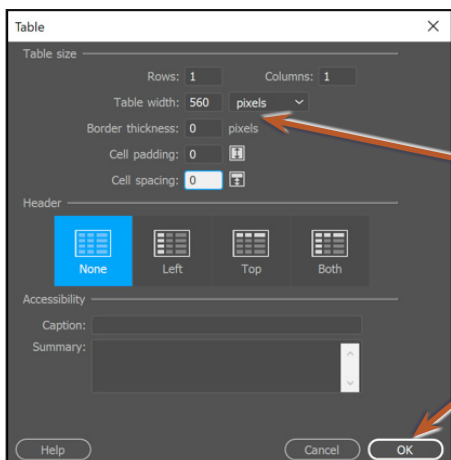

3 Set the table to have 1 ROW, 1 COLUMN, a WIDTH of 560 pixels, a BORDER THICKNESS of 0, a CELL PADDING of 0 and CELL SPACING of 0, then select OK to insert the single-celled table.

**NOTE: The table is set to a fixed width of 560 pixels so that it can be aligned with other objects in the form.**

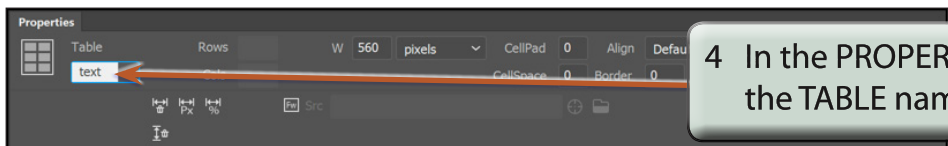

4 In the PROPERTIES INSPECTOR set the TABLE name box to TEXT.

5 Click in the table's cell and enter:

TravelWise provides quotes for travel packages online. Complete the following details and we will send prices to you within 24 hours of receipt of the form.

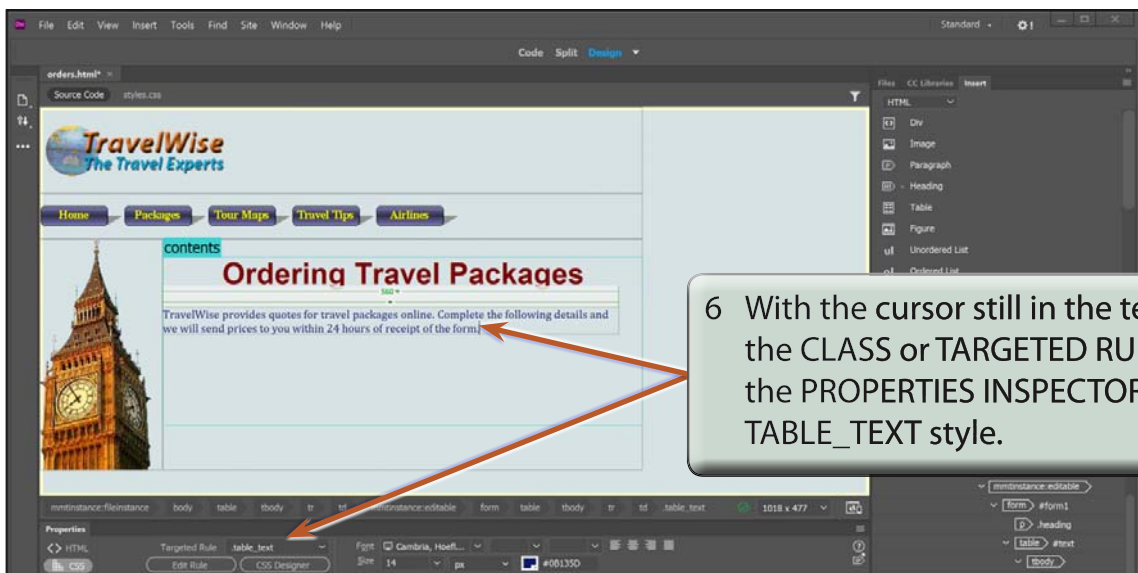

6 With the cursor still in the text, set the CLASS or TARGETED RULE box in the PROPERTIES INSPECTOR to the TABLE\_TEXT style.